

WALL MOUNT FIBER OPTIC DISTRIBUTION BOX



DESCRIPTION

Datacom Indoor Wall-Mount Fiber distribution enclosure (WODF) is designed for managing high-density fibre splicing in Building Entrance and Floor Telecom facilitates fulfilling FTTH requirements. WODF provides efficient cable connections between outside plant and equipment inside the buildings and communication facilities. Alternatively, the WODF can be installed at various floor telecom rooms/closets to facilitate cross-connection between the distribution cables and drop cables. The WODF has been constructed with a cold-roll steel box and has diligent excellent fibre management features to accommodate extra lengths of loose/micro loose tubes and 250/900-micron fibres. The WODF is equipped with splice tray mounted independently onto the splice holder frame. This allows access to individual cassettes without interfering with the other live fibres. The WODF can support from 24 up to 288 core splicing by means of independently mounted 24 fibre splice trays each supporting 12-Fibers.

APPLICATION

- Mainly used for FTTH Applications.
- Campus networking at MTR
- Enterprise building backbone consolidation point

FEATURES

- Large workspace to integrate the cables and pigtailed.
- Top and bottom cable entry plates
- Twin door with two locks
- 4-point wall mount holes.
- Optimum cable routing
- Independently mounted splice trays.
- PON and P2P FTTH networks

WALL MOUNT FIBER OPTIC DISTRIBUTION BOX

CONSTRUCTION

Dimension	600 (H) x 600(W) x 300 (W)
Weight	8 KG
Maximum Number Of Splice Trays	24
Maximum Number Of Splice Per Trays	12
Protective Sleeves	45/60 mm
Material	Body 1.2mm Steel, Other Elements 1.5mm
Powder Coating	RAL 7035
Operating Temperature	-40°C-+ 70°C
Storage & Transportation	-25°C-+ 55°C

TECHNICAL DRAWINGS

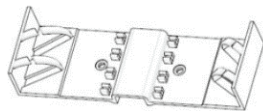
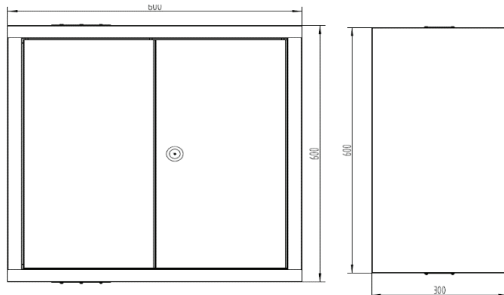
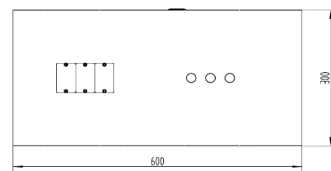

Spool Limiter

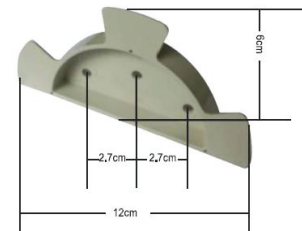
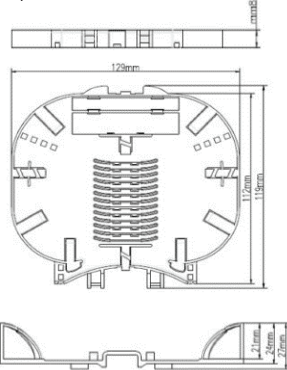

Hinged Splice tray

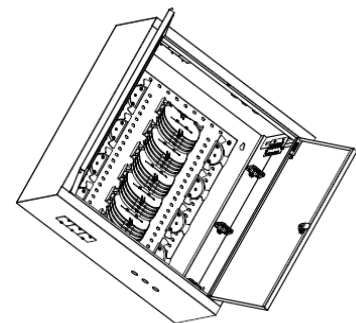

ORDERING INFORMATION

Description

**Datacom 144F Wall Mount Fiber Optic Distribution Enclosure
600(W) x 600(H) x 300(D) With 12 Splice Trays and Sleeves**

**Datacom 288F Wall Mount Fiber Optic Distribution Enclosure
600(W) x 600(H) x 300(D) With 24 Splice Trays and Sleeves**

Part No.

DC-WBU-FO-144SU

DC-WBU-FO-288SU